

Technical data sheet

Wall and support bracket AW 15 G

Item number: 6421282



Light-duty wall and support bracket with welded head plate.
When mounting the bracket on U supports up to a width of 400 mm, a truss-head bolt or a hexagonal bolt is used, depending on the profile, to fasten the support bracket. For bracket widths of 500 mm or more, the bracket is fastened through both struts of the U support using hexagonal bolts. Appropriate spacers are to be used, depending on the profile.



- St** Steel
- G** Electrogalvanized

Master data

Item number	6421282
Type	AW 15 16 G
Description 1	Wall and support bracket
Description 2	with welded head plate
Manufacturer	OBO
Dimension	B160mm
Material	Steel
Surface	Electrogalvanized
Surface standard	EN ISO 19598 / EN ISO 4042
Smallest sales unit	1
Unit of quantity	Piece
Weight	19 kg
Weight unit	kg/100 pc.

Technical data sheet

Wall and support bracket AW 15 G

Item number: 6421282



Dimensions

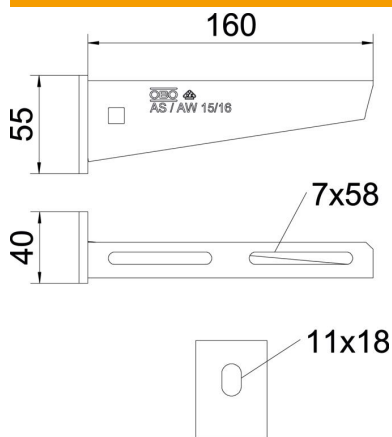

Width	160 mm
Height	55 mm
Dimension A	40 mm
Dimension B	160 mm
Dimension H	55 mm
Dimension L	160 mm

Technical data

Version for	Wall and support bracket
F in kN	1.5 kN
Maintain electrical functions	no
Hole diameter	11 mm
Rustproof steel, pickled	no
Angle range, max.	90 mm
Angle range, min.	90 mm

Loads

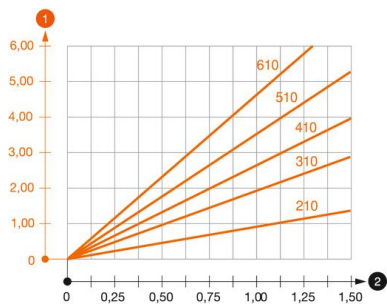

Load diagram, bracket, type AW 15

- 1 Bending of the bracket tip at permitted bracket load
- 2 Permitted bracket load in kN without man load
- Load curve with bracket lengths in mm

Characteristic anchor load values for wall and support bracket AW 15

Anchor type	Wall fastening							
	Max. load F [kN]							
	Bracket width [mm]							
	110	160	210	310	410	510	560	610
BZ-U 8-10-21/75	1.5	0.9	1.3	0.65	0.55	2.4	0.45	0.45
BZ-U 10-10-30/90	1.5	1.5	1.4	1.5	0.95	0.85	1.3	1.3

Max. total load F = cable weight + cable tray + bracket. The load capacity values increase considerably when used in uncracked concrete. Observe the load capacity of the brackets (diagram) and the installation conditions of the DIBt approval (anchors).